



**SPMEL155**

Design by Sandro Santantonio

Collection consisting of wall lamps, suspended lamps and floor lamps. The lampshades coming in various decorative patterns. Opalescent diffusers available on request. Screw fitting light source.

Typology: SUSPENDED

**Ratings**

- E27
- Downlight and uplight
- Surface installation over holes
- Supply voltage ~220-240V
- Switch mode: on-off
- Steel frame
- Optional opalescent diffusers

**Product code composition**

**MELTING POT** / diffusore NON INCLUSO / diffuser NOT INCLUDED

Type	Article	Colours	Finish	Source
SP	MEL 115	<b>BC</b> light patterns outside / white inside	XX white varnished metal	<b>E27</b> 4 x Max 16W LED or 4 x Max 23W fluo or 4 x Max 70W halo
		<b>BA</b> light patterns outside / silver inside		
		<b>BO</b> light patterns outside / gold inside		
		<b>NA</b> dark patterns outside / silver inside		
		<b>NE</b> dark patterns outside / gold inside		

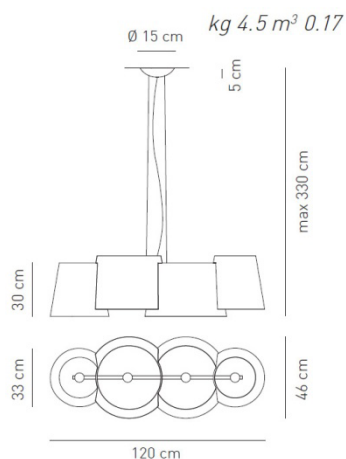

CE IP20 +LED

example composition code | SP | MEL115 | NE | XX | E27

For optional accessories please refer to our pricelist, website or contact our representatives

**Available colours**

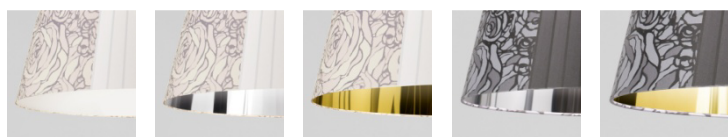

**BC** Light patterns outside / white inside  
**BA** Light patterns outside / silver inside  
**BO** Light patterns outside / gold inside  
**NA** Dark patterns outside / silver inside  
**NE** Dark patterns outside / gold inside

EELc (Energy Efficiency Label compatibility): E, D, C, B, A+, A++

SPMEL115\_XXE27

CUSTOMER \_\_\_\_\_ NOTES \_\_\_\_\_

**NOTICE:**

Luminous flux (lm) and efficacy (lm/W) for all integrated LED luminaires is estimated based on nominal ratings of the LED sources. Technical data could be subject to alteration without notice. Axo Light does not provide legal guarantee for the accuracy of this data sheet.