

Downlights | topLED 25 W 700 mA | CRI 80
92002N00

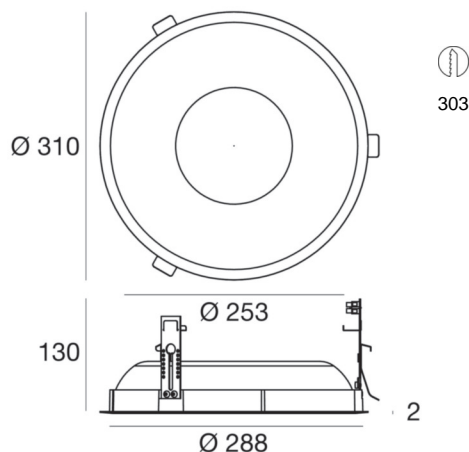

| Technical data | |
|--|------------------|
| Type | Frame |
| Installation position | Ceiling |
| Installation environment | Indoor |
| Light Source | LED |
| Optics | General Lighting |
| Power | 25 W |
| Luminous flux (source) | 3590 lm |
| Current intensity | 700mA |
| CCT / Tone | 4000 K |
| Colour rendering index | 80 Ra |
| C.C. / C.V. | CC |
| Energy class | A+ |
| Safety class | 3 |
| IP | IP40 |
| IK | IK05 |
| Glow wire test | 850° |
| Direct mounting on normally flammable surfaces | Yes |
| CE | Yes |
| ETL | No |
| Fire Rated (BS 476 PT21 compliant) | No |
| Operating temperature | -20°C / +50°C |
| Driver included | No |
| Induction | No |
| Emergency mode | No |
| Motion sensor | No |
| Directional | No |
| Tilting | No |
| Walk-over | No |
| Drive-over | No |
| Cable included | Yes |
| Cable length | 0.30 m |
| Resin potting | No |
| Type of light emission | Single emission |
| Net weight | 0.95 Kg |

Finishing casing

| | |
|------------|-------------------------|
| Material | Aluminium |
| Colour | embossed white RAL 9003 |
| Processing | Coating |

Electronics

| | |
|--|---|
| | 99330 DALI Push and Simply Dim Multi Power 190-250V AC / 180-275V DC |
| | 99188 DALI 1-10V Push and Simply Dim Multi Power 190-250V AC / 180-275V DC |
| | 99112 On/Off Driver 180-300V AC |

Downlights | topLED 25 W 700 mA | CRI 80
92002N00

Single emission downlights for indoor application. The natural white LED light source with a general lighting light distribution is composed of 192 topLED LEDs with CCT of 4000 K and a CRI 80; the source luminous flux is 3590 lm, with a 143.6 lm/W nominal luminous efficacy.

The device body is made of aluminium and features a embossed white ral 9003 finish, processed by means of coating. The ingress protection degree is IP40; the total weight is of 0.95 kg. The power supply driver is not provided and is to be ordered separately.

The total absorbed power is 25 W. The power supply cable is included and features.

The device features protection class III and can be ceiling-mounted, with a 303 mm diameter hole (in plasterboard).

| Illuminotechnical Features | |
|--|----------------|
| Light Output Ratio (LOR) | 59 % |
| Luminous flux (source) | 3590 lm |
| Luminaire luminous flux | 2150 lm |
| Consumption | 28 W |
| Luminaire efficacy | 77 lm/W |
| Colour temperature | 4000 K |
| Standard Deviation of Colour Matching | 2 Step MacAdam |
| Colour rendering index | 80 Ra |
| Life / Failure Ratio | |
| L70 B20 C0 70000h (at Tj 65 °C Ta 25 °C) | |

| UGR | |
|-------------------|----------|
| X=4H Y=8H | S=0.25H |
| Reflection factor | 70/50/20 |
| UGR transversal | < 28 |
| UGR axial | < 28 |

| OPTICAL | |
|-----------------------------|---------------|
| Light distribution simmetry | Symmetrical 2 |
| C0/C180 optics | 123° |
| C90/C270 optics | 127° |

