

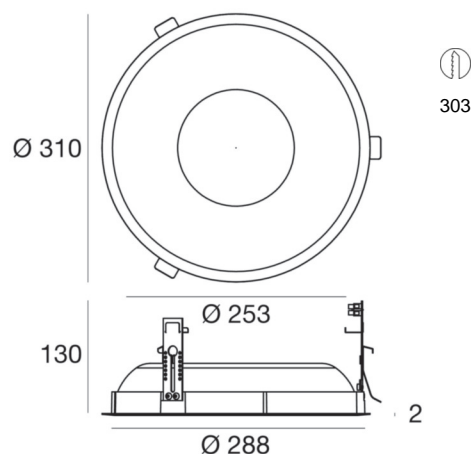

Downlights | topLED 25 W 700 mA | CRI 80
92002M00



| Technical data | |
|--|---------------|
| Installation position | Ceiling |
| Installation environment | Indoor |
| Light Source | LED |
| Optic | Diffused |
| Power | 25 W |
| Luminous flux (source) | 3283 lm |
| Current intensity | 700mA |
| CCT / Tonalità | 2700 K |
| Colour rendering index | 80 Ra |
| C.C. / C.V. | CC |
| Safety class | 3 |
| IP | IP40 |
| IK | 05 |
| Glow wire test | 850° |
| Direct mounting on normally flammable surfaces | Yes |
| CE | Yes |
| ETL | No |
| Operating temperature | -40°C / +90°C |
| Driver included | No |
| Induzione | No |
| Emergency mode | No |
| Motion sensor | No |
| Directional | No |
| Tilting | No |
| Walk-over | No |
| Drive-over | No |
| Cable included | Yes |
| Cable length | 0.30 m |
| Resin potting | No |

| Finishing casing | |
|------------------|-------------------------|
| Material | Aluminium |
| Colour | embossed white RAL 9003 |
| Processing | Coating |

Electronics

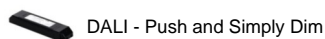
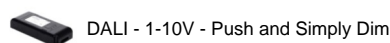
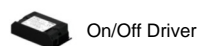

Downlights | topLED 25 W 700 mA | CRI 80
92002M00

Single emission downlights for indoor application. The super warm LED light source with a diffused light distribution is composed of 192 topLED LEDs with CCT of 2700 K and a CRI 80; the source luminous flux is 3283 lm, with a 131.3 lm/W nominal luminous efficacy and an operating lifetime (L70) of 100000 hours.

The device body is made of aluminium and features a embossed white ral 9003 finish, processed by means of coating. The ingress protection degree is IP40; the total weight is of 0.95 kg. The power supply driver is not provided and is to be ordered separately.

The total absorbed power is 25 W. The power supply cable is included and features.

The device features protection class III and can be ceiling-mounted, with a 303 mm diameter hole (in plasterboard).

| Illuminotechnical Features | |
|---------------------------------------|----------------|
| Light Output Ratio (LOR) | 59 % |
| Luminous flux (source) | 3283 lm |
| Luminaire luminous flux | 1961 lm |
| Consumption | 28 W |
| Luminaire efficacy | 71 lm/W |
| Colour temperature | 2700 K |
| Standard Deviation of Colour Matching | 2 Step MacAdam |
| Colour rendering index | 80 Ra |

| UGR | |
|-------------------|----------|
| X=4H Y=8H | S=0.25H |
| Reflection factor | 70/50/20 |
| UGR transversal | > 25 |
| UGR axial | > 25 |

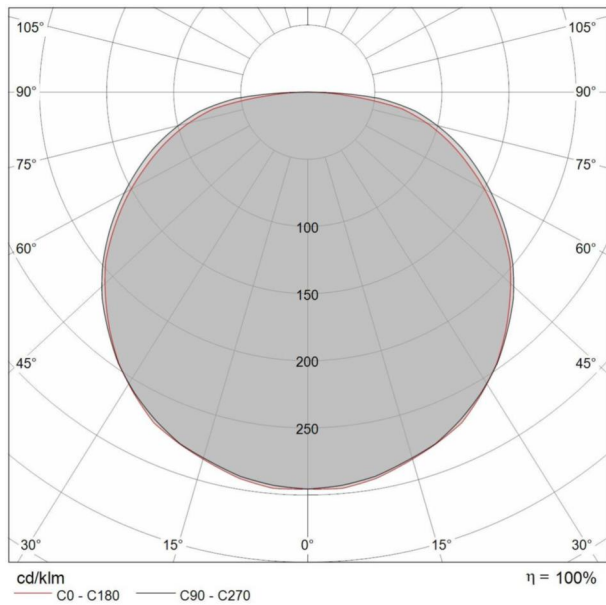

| Abstand [m] | Cone diameter [m] | Illuminance [lx] |
|-------------|-------------------|---|
| 0.5 | 1.99 1.86 | E(0°) 2318 E(C90) 63.3° 105 E(C0) 61.7° 124 |
| 1.0 | 3.98 3.71 | E(0°) 579 E(C90) 63.3° 26 E(C0) 61.7° 31 |
| 1.5 | 5.96 5.57 | E(0°) 258 E(C90) 63.3° 12 E(C0) 61.7° 14 |
| 2.0 | 7.95 7.43 | E(0°) 145 E(C90) 63.3° 7 E(C0) 61.7° 8 |
| 2.5 | 9.94 9.29 | E(0°) 93 E(C90) 63.3° 4 E(C0) 61.7° 5 |
| 3.0 | 11.93 11.14 | E(0°) 64 E(C90) 63.3° 3 E(C0) 61.7° 3 |

Abstand [m] Cone diameter [m] Illuminance [lx]
C0 - C180 (Hal beam angle: 123.4°)
C90 - C270 (Hal beam angle: 126.6°)