

## Safety Instructions

1, 2, 3, 4, 5, 6, 7, 8, 9, 12, 13, 15, 16, 19, 20,  
21, 22, 24, 25, 26, 27, 28, 33, 34



Info

[www.paulmann.com](http://www.paulmann.com)

Paulmann Licht GmbH  
Quezinger Feld 2  
31832 Springe  
Germany

[www.paulmann.com](http://www.paulmann.com)

Art.-Nr.: **709.01**

(+MA 326) PDN 05/17

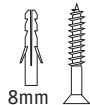
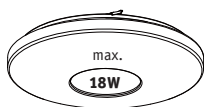

**A**

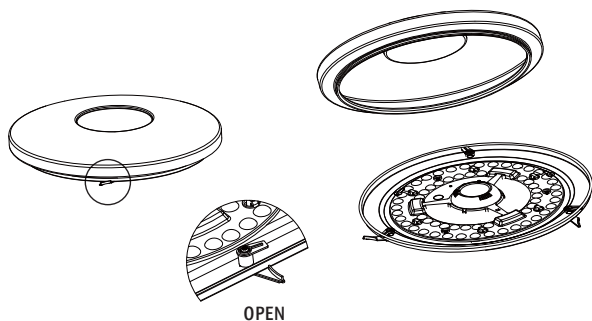

**B**



**Safety Instructions**  
Nr. 4, 5, 6, 7

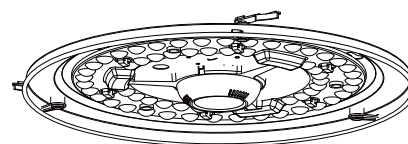
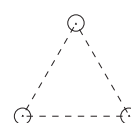
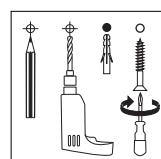

**C**



**Safety Instructions**  
Nr. 4, 5, 6

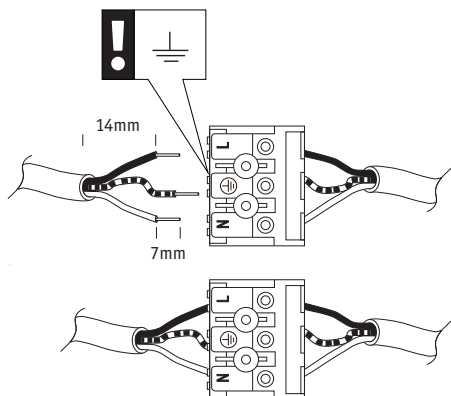

**D**

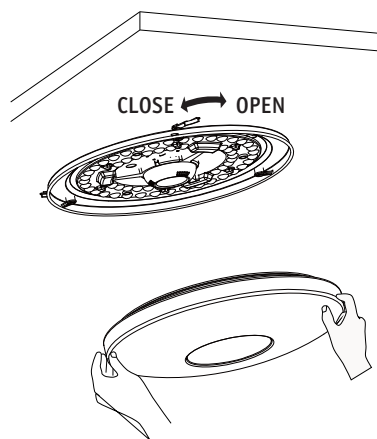

**E**

